

# First Year Student Newsletter

Volume 14.5

February 2010

Produced by  
Julie L. Amon, Assistant Dean for First Year Students  
Steven P. Scherger, Coordinator for First Year Student Academic Affairs  
and the Office of Undergraduate Studies

---

## Greetings from the Dean

---

# MAJOR DECLARATION

It's time to talk about major declaration again! At this point, many of you have declared, many more have a major in mind but have not completed the declaration process, and finally a smaller number of you are unsure of your academic interests. Most students declare a major by the end of their first year. However, students still in the process of exploring academic options are not required to declare within this time frame. It is important to recognize that in order to have a successful and engaged first year experience, all first year students should work toward the clarification of academic interests.

**YOUR MAJOR CAN BE CHANGED IF YOU CHANGE YOUR MIND LATER.** If you change majors later on, that's fine -- many students do change (or add) majors as they discover new interests. It's also OK to change your mind later and "undeclare." **IF YOU'RE TRULY UNDECIDED**, continue to explore, to talk with your advisor and other faculty members, and to use the resources of the Career Center (Sears 206, <http://studentaffairs.case.edu/careers/>). Steven Scherger and I would also be happy to discuss your interests and this process. So long as you are actively engaged in exploring your interests and in making a decision, you can declare your major in the future. You should not be concerned about making a "wrong" decision about a major. However, the best decision to make is an informed one, so be intentional about talking to people, reviewing information, and understanding requirements before you make a decision. The advantage of declaring a major is the close and formal connection that is established between students and academic departments.

**Those of you who have not declared yet, but are ready to do so should follow the steps listed below as soon as possible.**

1. Obtain the Major Declaration Form\* in the Office of Undergraduate Studies (Sears 357) or at the R.U.S.S. Office in Wade. Take the form to the department representative in your intended major for his/her signature and assignment of a major advisor. List of department representatives can be found at [http://www.case.edu/provost/ugstudies/Academic\\_Representatives.pdf](http://www.case.edu/provost/ugstudies/Academic_Representatives.pdf)
2. Students interested in Pre-Medicine/Pre-Dentistry and/or Pre-Law should be sure to mark the respective boxes on the declaration form.
3. Once completed, bring the yellow form to the Office of Undergraduate Studies, Sears 357. **The declaration of major is not official unless it is submitted to the Office of Undergraduate Studies.**

\* A separate form must be completed for each major that you declare.

---

## Summer Courses Off-Campus And Summer Courses at CWRU

---

Many of you have asked about taking summer classes at institutions other than Case. If you are one of these students and want to determine how you can take advantage of this option, read the information on the [Off-Campus Study Request Form](#). Once you have read the form and verified you can use the option, come to Sears 357 to have any additional questions answered. In order to complete the Off-Campus Study Request, you must collect course descriptions for the course(s) that you are interested in taking. The course(s) will be evaluated by Assistant Dean Claudia Anderson.

The deadline for submission of the request is **April 1, 2010**. Most universities and colleges begin to post summer schedules in February and March, and you need to submit the form when you have actual course offerings to review. However, the sooner you complete the form, the sooner you will be notified if the course you are interested in taking has been approved. (For those of you who live in Cuyahoga County, please pay special attention to the specific residency restrictions listed on the Off-Campus Study Request Form.

### **Don't forget that Case also offers summer courses!**

The preliminary Summer 2010 schedule is available at <http://www.case.edu/academics/summer/index.html>. The Summer term features a three-week intensive May Term, a full year of physics, organic and introductory chemistry, the biology core courses, SAGES university seminars and 70 other great classes. Summer tuition for courses numbered 1-399 is 50% of regular tuition.

## Inside this Issue

- Summer Classes
- Spring SI Schedule
- R.U.S.S. Hours
- Financial Aid Application, Information, and Deadline
- Spring Semester Final Exams Schedule
- Making Up Incompletes
- How to Withdraw from a Course
- Academic Standing & Scholarship Retention
- Merit Based Scholarship Application
- Academic Integrity Week
- Internship and Career Fair
- Wittke & Jackson Award Nominations
- Engineers Week
- Winter Leadership Conference
- SatCo

**Educational Services for Students  
FREE Help with Your Courses**

ESS provides two high quality programs for FREE!

If you need individual help with a course, Peer Tutors are available to assist you. Appointments may be made using the TutorTrac program. Instructions for making an appointment are available on the ESS website: <http://studentaffairs.case.edu/education/resources/tutoring/>.

The Supplemental Instruction (SI) program provides additional support in traditionally difficult courses. SI sessions allow you to practice problems with guidance, provide explanations of concepts in your language, and help you gain a deeper understanding of the material. SI Leaders are your peers who have been selected by instructors based on their previous success in the course. For more information visit: <http://studentaffairs.case.edu/education/resources/supplemental/>

Course	Day	Time	Location	SI Leader
BIOL 117	Fri	2:30pm-4:00pm	NOA 290	Jacklynn Sanford
	Sun	12:30pm-2:00pm	NOA 290	Jacklynn Sanford
BIOL 119	Thur	7:00pm-8:30pm	Clark 205	Tessa Polakowski
	Sun	3:00pm-4:30pm	Wade MPR	Tessa Polakowski
BIOL 214	Mon	7:30pm-9:00pm	Sears 480	Matt Wells
	Tue	7:00pm-8:30pm	Clark 308	(All SI Leaders)
	Wed	8:00pm-9:30pm	Clark 302	Catherine Osborn
	Thu	6:30pm-8:00pm	Clark 302	Meridith Ginesi
BIOL 216	Mon	8:00pm-9:30pm	Fribley 211	Bo Chen
	Wed	8:00pm-9:30pm	Nord 204	Lucy Bollinger
	Thur	8:00pm-9:30pm	Sears 462	Matthew Boes
	Sun	1:30pm-3:00pm	Nord 204	(All SI Leaders)
CHEM 106	Mon	6:00pm-7:30pm	Sears 480	Michelle Klepatzki
	Tue	5:30pm-7:00pm	Clark 308	Sipa Yankey
	Wed	6:30pm-8:00pm	GUIL 323	(All SI Leaders)
	Sun	1:30pm-3:00pm	Wade MPR	Lindsey Rubino
CHEM 224	Mon	6:30pm-8:00pm	Nord 204	Aya Du
	Tue	6:30pm-8:00pm	Nord 204	Jonathan Weis
	Wed	6:30pm-8:00pm	Nord 204	Aya Du
	Thur	6:30pm-8:00pm	Nord 204	Jonathan Weis
COGS 102	Mon	7:00pm-8:30pm	MTHM 125	Benjamin Kubit
	Wed	7:00pm-8:30pm	MTHM 125	Benjamin Kubit
ENGR 145	Tue	6:00pm-7:30pm	Clark 302	Paul Thompson
	Thur	6:00pm-7:30pm	MTHM 125	Daniel Vasil
MATH 122	Sun	6:00pm-7:30pm	Clark 308	Paul and Daniel
	Mon	2:00pm-3:00pm	Yost 321A	Rebecca
	Mon	6:30pm-8:00pm	Wade MPR	Mark, Anna, Nora, Rebecca
	Mon	8:00pm-9:30pm	Wade MPR	Alex, Anna, Steve
	Tue	9:30am-11:00am	Yost 321A	Rebecca
	Tue	10:00am-11:00am	Yost 321A	Steve
	Tue	10:00am-11:15am	Yost 321A	Alex
	Tue	12:30pm-2:00pm	Yost 321A	Alex
	Wed	10:30am-11:20am	Yost 321A	Anna
	Wed	11:30am-12:30pm	Yost 321A	Nora
	Wed	12:30pm-1:45pm	Yost 321A	Mark
	Thur	12:00pm-1:00pm	Yost 321A	Mark
	Fri	10:30am-11:30am	Yost 321A	Nora
	Fri	1:00pm-2:00pm	Yost 321A	Steve
MATH 125	Mon	2:00pm-3:00pm	Yost 321A	Rebekah
	Mon	4:00pm-5:00pm	Yost 321A	Libby
	Mon	7:00pm-8:00pm	Wade MPR	Libby, Rebekah
	Wed	12:30pm-1:30pm	Yost 321A	Isaac
	Wed	2:00pm-3:00pm	Yost 321A	Rebekah
	Thu	11:30pm-12:30pm	Yost 321A	Isaac
	Fri	1:30pm-2:30pm	Yost 321A	Libby

**SPRING 2010 SI Schedule (cont.)**

Course	Day	Time	Location	SI Leader	
MATH 126	Mon	12:30pm-1:30pm	Yost 321A	Claudia	
	Mon	3:00pm-4:00pm	Yost 321A	Julie	
	Mon	6:30pm-8:00pm	Wade MPR	Matt, Claudia	
	Mon	8:00pm-9:30pm	Wade MPR	Julie	
	Tue	10:00am-11:30am	Yost 321A	Matt	
	Wed	1:00pm-2:00pm	Yost 321A	Matt	
	Wed	3:00pm-4:00pm	Yost 321A	Kyle	
	Wed	4:00pm-5:00pm	Yost 321A	Claudia	
	Thur	11:30am-12:30pm	Yost 321A	Leah	
	Thur	8:00pm-9:30pm	Yost 321A	Kyle, Leah	
	Fri	1:00pm-2:00pm	Yost 321A	Leah	
	PHYS 116	Tue	4:30pm-6:00pm	Nord 204	Kelsey and Akash
		Thur	4:30pm-6:00pm	Nord 204	Akash Kataruka
		Sun	5:00pm-6:30pm	Clark 302	Kelsey Cornelius
PHYS 121	Wed	5:30pm-7:00pm	Wade MPR	Bryan Schmidt	
	Thur	7:30pm-9:00pm	Clark 308	Danielle Pajerski	
	Sun	7:30pm-9:00pm	Clark 302	Bryan and Danielle	
PHYS 122	Tue	7:30pm-9:00pm	Clark 302	David and Michael	
	Thur	7:30pm-9:00pm	MTHM 225	David Karnick	
	Sun	7:30pm-9:00pm	Clark 308	Michael DeLibero	
PHYS 221	Thur	8:00pm-9:30pm	Clark 302	Gareth Kafka	
	Sun	7:30pm-9:00pm	Nord 204	Gareth Kafka	

**R.U.S.S. (Residential Undergraduate Studies Satellite) Office  
Monday and Tuesday Evenings, 6:00 – 8:00 p.m.  
Wade Area Office**

The R.U.S.S. Office provides students the opportunity to meet with Dean Julie Amon and Steven Scherger regarding academic concerns, withdrawing from classes, getting connected with academic opportunities at CWRU, and other brief questions.

Contact the main Office of Undergraduate Studies at 368-2928 or <http://www.case.edu/provost/ugstudies/walkinhours.htm> to check about weekly walk-in availability.

**Important News from the Financial Aid Office**

The application process for financial aid for the 2010-2011 academic year will begin in February with the release of the on-line **CASE FORM**, forms library, and application status option in **briefCase**. Students will be notified of the availability of these options via e-mail. The aid year covers the summer session 2010 and the fall and spring semesters. The application deadline is **May 15, 2010**, and applications completed after that date will be awarded with remaining funds available.

All applicants for financial aid will need to complete the **2010-2011 Free Application for Federal Student Aid (FAFSA)** at [www.fafsa.gov](http://www.fafsa.gov) using the Federally-assigned Personal Identification Number (PIN). Both the student and a parent must sign the form using the PIN. Families should not file the 2010-2011 FAFSA until they have completed their 2009 Federal Income Tax Return 1040 to ensure figures reported on the FAFSA are accurate.

The 2010-2011 Case Form and FAFSA are required of all applicants for financial aid. Some applicants will be selected for verification of the information reported on the FAFSA. These students will be contacted by the office to submit signed copies of student and parent 2009 Federal Income Tax Returns, W-2 Forms, and to complete a Verification Form. Students with special circumstances are encouraged to contact the office directly for information on submission of information about their situation.

Students receiving academic scholarships only are NOT REQUIRED to submit the FAFSA for renewal of the award(s). Scholarship retention is based upon the student's academic performance, not financial need (see p. 3 for guidelines).

**Course Repeat Option**

If you are dissatisfied with a grade that you received, you may choose to repeat that course. Upon completion of the repeated course at Case for an evaluative grade (A, B, C, D or F), the first grade will remain visible on the transcript, but will be removed from the calculation of the cumulative grade point average and the original semester in which the grade was earned. The second grade will then be used for calculation into the cumulative grade point average, even if it is not the better grade. If the Course Repeat Option is applied, the student's transcript will show the comment "GRADE NOT COUNTED. COURSE REPEATED." directly below the course.

The Course Repeat Option may be exercised subject to the following conditions:

1. A student may not use the Pass/No Pass option in a course that is being repeated.
2. An academic action that occurred under the earlier grade is neither reversed nor removed from the record as a result of a change in the semester or cumulative averages that results from the repetition of one or more courses.
3. All grades earned at Case Western Reserve University, including those grades removed as a result of the application of the Course Repeat Option Policy, will be applied to the Scholarship GPA that is reviewed in order to determine Case Western Reserve University merit-based scholarship retention.

**Spring Final Exams Schedules**

By now you should have reviewed your spring final exam schedule. It is important that you consult your course syllabi and the on-line final exam schedule. Final exams dates **will not** be altered to accommodate travel plans. You can find the Final Exam Schedule on the Registrar's website at <http://www.case.edu/provost/registrar/exams.html>. Make sure you confirm your exam schedule and make your travel, work or school plans accordingly.

4/26	Last Day of Classes
4/27 – 4/28	Reading Days
4/29	Final Exams Begin
5/6	Final Exams End

NOTE: No student will be required to take more than two final examinations on a single day. A student who has three final examinations scheduled for a single day should go to the Office of Undergraduate Studies and obtain the assistance of Dean Jeffrey Wolcowitz in arranging to take one of those examinations on an alternative day during the final examination period. Similarly, a student with conflicting examinations should seek the assistance of Dean Wolcowitz in arranging to have the time of one examination changed.

**Making Up Incompletes for Fall Semester**

If you received a grade of "I" (Incomplete) for the Fall Semester, it is your responsibility to meet with your professor and make arrangements to complete the unfinished work as soon as possible. All incomplete work must be completed and a grade change submitted to the Office of Undergraduate Studies **no later than March 26, 2010**. Any "I" not made up by this date will be converted to a grade of "F."

Any request for an extension must be submitted well in advance for review by the Dean's Committee. A request for extension should be submitted to Dean Jeffrey Wolcowitz ([jeffrey.wolcowitz@case.edu](mailto:jeffrey.wolcowitz@case.edu)) in Sears 357 and must be accompanied by a supporting note from the professor in the course involved.

**Maintaining Good Academic Standing**

Academic standing comprises two elements: credit hours earned at Case and grade point average (GPA). In order to achieve good academic standing by the end of the spring semester, first year students must earn **EITHER 12 credit hours and a GPA of 2.000 for the Spring Semester OR a total of 21 credit hours and a cumulative GPA of at least 1.750.**

**Scholarship Retention**

At the end of each academic year, the records of all scholarship recipients will be reviewed. To have a scholarship renewed for the following academic year, a recipient is expected to satisfy two requirements: a minimum number of hours earned after enrolling at Case and a minimum scholarship GPA\*. In order to retain your Trustee's, President's Provost's, Dean's, Faculty Honors, or Faculty Scholarship you must have earned at least 24 credit hours with a cumulative scholarship GPA\* of 2.500. To retain your Provost's Special Scholarship you must maintain good academic standing (see above section).

\*The Scholarship GPA includes all courses posted for grades including both grades earned through the use of the Course Repeat Option. Therefore, the statement, "I'll just take an F because the Course Repeat will save me" represents a very ill-advised strategy. If you are facing a possible D or F in a course, it makes more sense to withdraw than it does to risk the impact on your GPA and the possible loss of your scholarship.

**Case Merit-Based Scholarship Opportunities**

Case Western Reserve University will award a limited number of scholarships for 2010-2011 and subsequent years to students who are currently enrolled at Case and who have compiled a record of achievement, participation, and leadership that distinguishes them from their peers.

The following scholarships will be available for the 2010-2011 academic year: One Trustee Scholarship, Two President's Scholarships, and Four Provost's Scholarships. **The deadline to apply for these scholarships is April 26, 2010.**

To be eligible for consideration:

1. Students must be a US citizen or Permanent Resident (Green Card)
2. Students must be a first, second, or third year student in 2009-2010 who have not previously received a merit scholarship (i.e. Trustee's, President's Provost's, Provost's Special, Dean's, Faculty Honors, or Faculty Scholarship)
3. Students who entered as first year students in Fall 2009 must have earned a cumulative grade point average of at least 3.750 and at least 30 credit hours earned at Case in the academic year 2009-2010.
4. Students who entered Case in Fall 2007 or in Fall 2008 must have earned by May 2010 a cumulative grade point average of at least 3.750 and averaged at least 15 credit hours for each semester of enrollment at Case.

For additional information regarding these merit-based scholarships, the application process, and other scholarships opportunities for current students, go to

<http://www.case.edu/provost/ugstudies/scholarships/S-merit.htm>

---

### Withdrawing from a Course

---

As a first year student subject to the First Year Student Withdrawal Policy, you may withdraw from a course(s) up until the last day of classes, which this spring is **April 26, 2010**. In order to withdraw from a class, **you must complete a Drop/Add Form (available in Sears 357; Wade Commons; or Yost 110) and get the signature of your advisor**. Once that is complete, **come to the Office of Undergraduate Studies in Sears 357 for a Dean's signature**. **After you secure a Dean's signature, you must take the form to the Registrar's Office in Yost 110 for processing.**

Before you seek approval for a withdrawal, please take the time to reflect and review the following issues:

- Why are you withdrawing from this course? How are the rest of your courses going this semester? How do you feel about the withdrawal?
- Have you talked to your professor about your progress/success in the course?
- Have you reviewed the syllabus? Do you know what your chances for improved success are in the course?
- Have you taken advantage of support resources: professors' office hours, tutoring through ESS, SI's, etc.
- Have you thought about how this withdrawal will impact your plans for next semester? Will this withdrawal have an impact on your degree completion?
- Have you considered if Pass/No Pass is an appropriate option?

First year students who withdraw from a course in their first two semesters of full-time enrollment will not have the withdrawn course listed on their official transcript. However, the transcript will indicate all attempted hours, including those representing a course(s) that was withdrawn.

---

### Integrity Week 2010

<http://studentaffairs.case.edu/groups/aiboard/iweek/>

February 1 – February 5

---

#### Tuesday, February 2 – Pamphlet Competition

11:30 a.m. – 1:00 p.m., 1914 Lounge, Thwing  
The Academic Integrity Board needs YOU! Design a pamphlet for our group and you might just win an awesome prize!

#### Wednesday, February 3 – Tie Dye with the Academic Integrity Board

11:00 a.m. – 1:00 p.m., Thwing Atrium  
Tie dye your free Integrity Week t-shirt and meet some of our friendly members!

#### Thursday, February 4 - Student/Faculty Panel

11:30 a.m. – 1:00 p.m., Nord 310  
Come out and see your fellow peers and professors discussing relevant issues in ethics and integrity both in the academic world, as well as in our greater society. Free lunch provided!

#### Friday, February 5 - Keynote Speaker, David Callahan

12:30 p.m. – 2:00 p.m., Thwing Ballroom  
Renowned author of *The Cheating Culture* and *The Moral Center*, David Callahan is an expert on our society's views of ethics and morality. This event is open to the public, and is free to attend.

---

### SAGES Writing Portfolio

---

Although you just finished your First Year Seminar and still need to complete two University Seminars over the next three semesters it is never too early to begin preparing your SAGES Writing Portfolio. Students who fail to plan properly will find it difficult to meet the requirements of the Writing Portfolio as you will be required to submit past work from each of your seminars: an essay from your First Seminar, an essay from a University Seminar, and a research essay from a University Seminar. For further instructions regarding the SAGES Writing Portfolio visit <http://www.case.edu/sages/portfolio.htm>

One of the best preparations you can take now for the Writing Portfolio is to secure your papers. In the past, a number of students have had difficulties submitting their essays because the electronic copies of them were lost due to computer malfunctions and lost computer drives. To prevent these losses, it is highly recommended that you save copies of your papers in the filer folders at [filer.case.edu](http://filer.case.edu). Each student is given 500MB of free space through the service, which should be more than enough for you to store all of your SAGES papers, as well as essays and assignments from other courses you may want to keep for future applications to professional and graduate schools.

---

### SAGES Peer Writing Crew

---

The SAGES Peer Writing Crew is here to help you with your essays! If you want to work with a friendly fellow student to improve your paper, check out our many services at <http://ess.case.edu/writingcrew>.

The Crew consists of undergraduates who have been through SAGES and been recommended by their professors; they can help you strengthen your prose and develop your authorial voice! To make an appointment, simply go to [tutortrac.case.edu](http://tutortrac.case.edu).

---

### Presentation Workshop Series: Powerful Presentation Skills

---

ESS is once again hosting the **Presentation Workshop Series** this Spring Semester.

Educational Services for Students (ESS) is once again conducting a series of presentation workshops this Spring Semester, which focus on enhancing students' skills as presenters. Student will learn ways to organize their work, understand their audience, use appropriate visual aids, and speak with confidence.

To reserve a spot for any of these workshops, register at [ess.case.edu/resources/presentation.html](http://ess.case.edu/resources/presentation.html) no later than 5:00 p.m. the day before the workshop. All workshops will be from **4:30-5:30 in Sears 480**. The location will be confirmed at registration. These workshops are available on a first-come, first-served basis; some workshops have limited seating arrangements.

If you have questions, please contact the workshop leaders: Rhonda Moore ([rhonda.moore@case.edu](mailto:rhonda.moore@case.edu)) or Van Bray ([van.bray@case.edu](mailto:van.bray@case.edu)), or call ESS at 368-5230. ESS is located in Sears 470



---



---

**Career Center News!**

---



---

**Get Experienced! Featuring...The Alumni Interns**  
**Thursday, February 4, 2010, 6:00 – 7:30 p.m.**  
**Nord 310**

Hear from the Alumni Interns Panel where CWRU seniors and recent alumni who have been able to leverage internships and other experiential learning opportunities to get first-rate jobs. Panelists will represent the arts, sciences, business and engineering fields. For more information and registration: <http://studentaffairs.case.edu/careers/student/events/20872.calx>

**Get Experienced! Internship and Career Fair**  
**Thursday, February 11, 2010, 11:00 a.m.—3:00 p.m.,**  
**Adelbert Gym**

The Get Experienced! Internship and Career Fair is full of experiential learning opportunities! It is a chance for students and alumni to find resources for a practicum, internship, co-op, or full-time job. Please bring multiple copies of your resume and dress professionally. For more information: <http://studentaffairs.case.edu/careers/student/fairs/feb2010.html>

**Accenture Women's Networking Forum: Stretch Yourself**  
**Friday, February 19, 2010**  
**Time and Place: TBA**

The forum will focus on how all women stretch themselves to accomplish multiple, often conflicting priorities at school, work, home and in the community. Participants will learn how to "up-tap" their potential and hear from several Accenture women who have done the same. For more information: <http://studentaffairs.case.edu/careers/news/3374.newx>

---



---

**Wittke Award for Excellence in Undergraduate Teaching**  
**Jackson Award for Excellence in Undergraduate Mentoring**  
**Nomination Deadline: March 10, 2010**

---



---

Do you have a favorite professor who deserves to be recognized for outstanding teaching? Has a faculty or staff member mentored you during your time at Case? Would you like to see these individuals recognized for their outstanding commitment to you as a student?

Nominations for the 2010 Wittke Award for Excellence in Undergraduate Teaching and the 2010 Jackson Award for Excellence in Undergraduate Mentoring are now being accepted through March 10, 2010. For more information and to make an on-line nomination, go to: <http://studentaffairs.case.edu/awards/wittke/>  
<http://studentaffairs.case.edu/awards/jackson/>

---



---

**Case Engineers Week**  
**February 11—February 19, 2010**

---



---

**Thursday, February 11**
**Introduce a Girl to Engineering Day**

WISER presents its second annual "Introduce a Girl to Engineering Day" to promote engineering as a strong career option to girls grades K-12. WISER members will host 75 middle-school students as they visit various CSE labs and participate in hands-on activities. Interested in volunteering? Contact [Mary Rouse](#).

**Saturday, February 13**
**Case Engineering Challenges Carnival**

*Great Lakes Science Center, 1:00 – 4:00 p.m.*

Join us for fun and educational afternoon of hands-on experiments, puzzles, and games developed by Case engineering students and Parker Hannifin.

**Monday, February 15**
**Lecture: Entrepreneurship Influenza**

*Nord 310, 5:00 p.m.*

Do you have an inner drive to succeed? Are you always searching for new ideas and innovation? Are you highly motivated and energetic, as well as accepting of rejection and failure? Do you possess a strong belief in yourself and have an openness to change? If you or anyone you know shows signs of these symptoms, we challenge you to attend this presentation by Mark Canter.

**Tuesday, February 16**
**Society of Women in Engineering Luncheon**

*Nord 310, 12:00 – 2:00 p.m.*

An annual lunch celebrating the past, present, and future of women in engineering. This lunch will feature Karen Sing, who will discuss the controversial swimsuit that has professional and amateur swimmers alike in a frenzy.

**Thursday, February 18**
**E-Week Banquet**

*Windows on the River, 6:00 p.m. cocktail hour, 7:00 p.m. dinner*  
 Sponsored by Accenture and the Case Alumni Association.  
 Speaker: Joseph A. Kovach ('75, '80, '86), Vice President of Technology & Innovation, Keithley Instruments, Inc. Contact [Maria Marzano](#) or 216-368-5024 if you are interested in attending this year's banquet.

For more information about Engineers Week and all of its events, including Faculty Egg Drop, Lego Robotics Competition, Video Game Competition, Obstacle Course, and many others, visit <http://www.engineering.case.edu/cec/eweek/>.

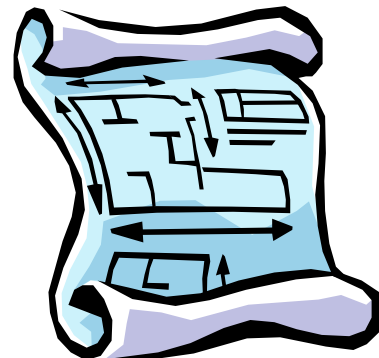

**Winter Leadership Conference**

**“Gleadership: A Conference for the Leader in All of Us”**  
**February 6, 2010, 11:30 a.m. – 4:00 p.m.**



The 2010 Winter Leadership Conference theme “Gleadership” is based on the hit show “Glee”, which depicts the challenges faced by an unlikely team of underdogs as they strive to make the Glee club great again. Its message is one of perseverance and demonstrates the value of teamwork, diversity, and passion. Conference participants will choose from a variety of sessions to personalize the conference towards their goals, so they can realize their true leadership potential.

**Cost:** FREE to CWRU students; \$10 for non-CWRU students

**Location:** Nord and Sears (check-in is in the Nord Atrium)

**Registration:** Online until 5:00 p.m., on Friday, February 5 at <http://studentaffairs.case.edu/programs/leadership/> or in-person the day of the conference.

**Orientation Leader Applications**

**DEADLINE: Monday, February 8, 2010**

Remember all of those helpful students last summer when you came to campus during Orientation? The one's who answered all of your questions and helped you find your way around campus. Now you have the opportunity to do the same for the Class of 2014 by becoming an Orientation Leader!

Orientation Leader applications are available online at [www.case.edu/orientation](http://www.case.edu/orientation). Be sure to submit your application by **Monday, February 8**. If you have questions, contact [orientation@case.edu](mailto:orientation@case.edu) or 216-368-8827.

**2010 Dr. Dorothy Pijan Student Leadership Awards**

The nomination process for the **2010 Dr. Dorothy Pijan Student Leadership Awards** is underway! The timeline and process are as follows:

Nominations Begin: **Monday, February 1**

Nominations Deadline: **Friday, February 19 at 5:00 p.m.**

Case Western Reserve University faculty, staff, and students may submit nominations online at: <http://studentaffairs.case.edu/awards/leadership/>.

Over 20 different [student leadership awards](#) will be presented during the annual awards ceremony on **Thursday, April 15th**. Please take this opportunity to recognize undergraduate students, advisors, organizations, and/or campus programs that have made a positive impact on the Case Western Reserve University community.

The Student Leadership Awards were created by Dr. Dorothy Pijan in 1982 to recognize and honor Case's outstanding undergraduate student leaders. Dr. Pijan worked at Case Western Reserve University as the director of Thwing Center and Student Activities from 1982-2003. Dr. Pijan was a well-respected and nationally known student union professional. She had an incredible passion, drive and dedication to student leadership. After her death in 2003, the awards were named in her honor to recognize her many contributions to student life at CWRU.

For more information, please contact [Christina Mastrangelo](#) at 216.368.2679.

**7<sup>th</sup> Annual Faculty/Staff v. Student Basketball Game**  
**Friday, February 26th, 5:30 p.m.**  
**Veale Center**

We are excited for another year of spirited fans and a competitive match between the two teams. Last year, the faculty/staff beat the students in a close game, breaking the students' winning streak from previous years.

With prizes, an energetic half-time show, and food, you are sure to have a great time!

<http://studentaffairs.case.edu/programs/sharethevision/bb/>

**Spring SatCo 2010**  
**Saturday and Sunday, February 27-28, 2010**

SatCo offers unique non-credit, no-tuition courses which are held on a Saturday during each academic semester. Courses are open to all Case students, faculty, staff, and alumni, as well as community members. Most programs have no charge, however, some programs may have a fee, such as sky diving, jewelry making, rock climbing, etc.

For information about this semester's SatCo schedule, visit <http://studentaffairs.case.edu/programs/satco/>

**Movies**

All movies listed below will be shown at Strosacker Auditorium. For more information, go to <http://films.cwru.edu/>

- 2/5 (500) Days of Summer**  
7:00 p.m., 9:00 p.m., 11:00 p.m.
- 2/6 6<sup>th</sup> Annual Local Filmmaker's Night**  
7:00 p.m.
- 2/12 Inglourious Basterds**  
7:00 p.m., 10:00 p.m.
- 2/13 Grand Torino**  
7:00 p.m., 9:30 p.m.
- 2/19 Food, Inc.**  
7:00 p.m., 9:00 p.m., 11:00 p.m.
- 2/20 Citizen Kane**  
7:00 p.m., 9:30 p.m.
- 2/25 Indiana Jones and the Last Crusade**  
7:00 p.m.
- 2/26 The Boondock Saints II: All Saints Day**  
7:00 p.m., 9:30 p.m., 12:00 a.m.
- 2/27 A Beautiful Mind**  
7:00 p.m., 10:00 p.m.